

2x4 JUNCTION BOX WITH 3/4" CONDUIT & COVER PLATE FOR 110V, 20 AMP SERVICE TO DEPOSITORY

90° BRACKET ON EACH SIDE SUPPLIED AS SUPPORT FOR CONDUIT

1/2" HOLE ON BOTH SIDES SUPPLIED FOR CONDUIT

ANTI-FISH 169g PLATE

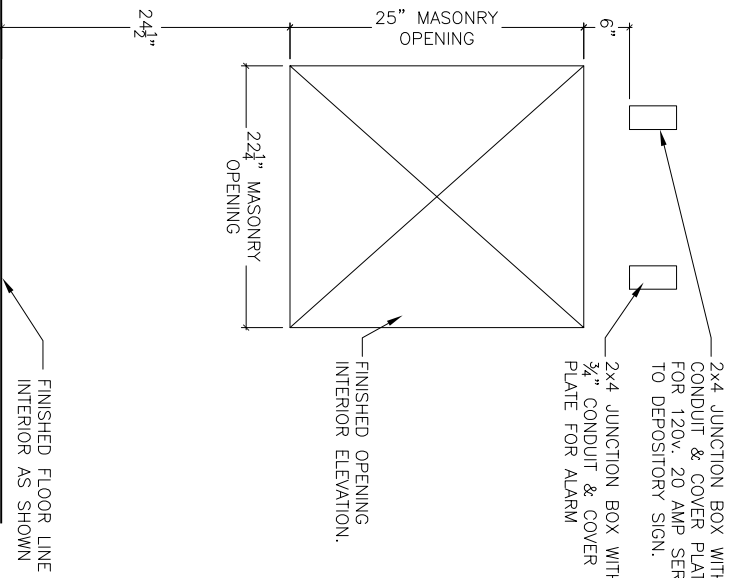

3/4" CONDUIT FOR 110V, 20AMP SERVICE TO DEPOSITORY

3/4" CONDUIT FOR ALARM

1/2" HT CHUTE

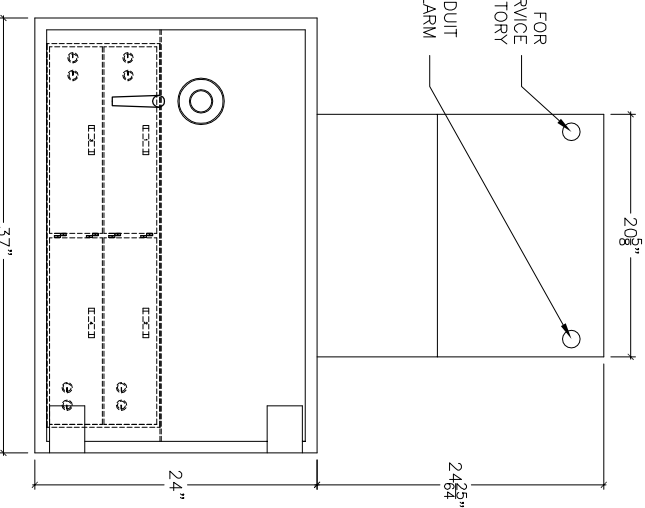
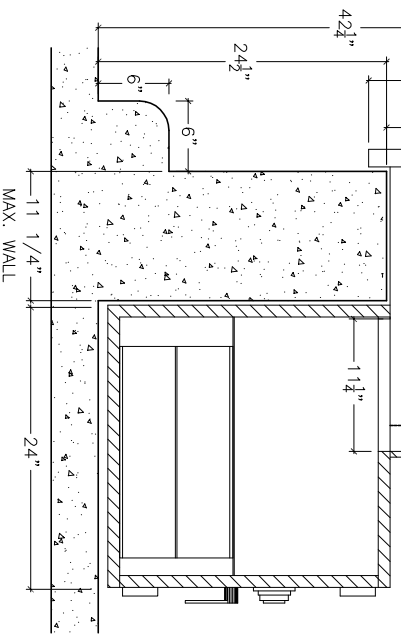

NOTE: ELECTRICAL BY OTHERS

NOTE: UNLESS OTHERWISE REQUESTED, BELOW, SAFE WILL BE RIGHT-HAND SWING.

SPECIFICATIONS

HEAT THERMO & DC	<input checked="" type="checkbox"/>	SEISMIC ALARM	<input type="checkbox"/>	STANDARD STAINLESS STEEL DOOR	<input type="checkbox"/>
TIME LOCKS	2MM	No. OF UNITS	<input type="text"/>	SHIPPED LOCALLY	<input type="checkbox"/>
ELECTRONIC LOCK	<input type="checkbox"/>	FINISH PLATES	<input type="checkbox"/>	GUARD KEY #	<input type="text"/>
LEFT SWING	<input type="checkbox"/>	RIGHT SWING	<input type="checkbox"/>	FILLER PLATES	<input type="checkbox"/>
				SEE DWG #	<input type="text"/>

CLIENT APPROVED: _____

DATE: _____

LANE BANK EQUIPMENT

5921 Centalcrest
Houston, TX 77092
(713) 682-5263 1-800-245-6765

LANE CUSTOM SAFES & AHDS

CHEST w/AHD

SCALE: Not Scale

DRAWN BY: T. NATEIL

DATE: 08/02/06

DWG NO.: 700-117 (180)

CUT-SHEET

FILE: Lane700117-22006

24" x 37" x 24" AHD w/Lockers/Shell